



DGENTR LOT 6: Air conditioning and ventilation systems **Project introduction**

ARMINES, BRE, VHK

<http://www.ecohvac.eu>

Philippe Rivière, ARMINES

Timetable

Stakeholder meetings

Draft reports



Contents

- Stakeholder meetings
- Draft reports 1,2 and 3
- Timeline

Timetable

Stakeholder meetings

Draft reports



Timetable

Jan 2010	Project launch
June/ July 2010	Draft report: Tasks 1,2 & 3 (part 1)
July 2010	1st stakeholder meeting
Dec 2010/ Jan 2011	Draft report: Tasks 3 (part 2), 4 & 5
Jan 2011	2nd stakeholder meeting
June/ July 2011	Draft final report (incl. Tasks 6, 7)
July 2011	3rd stakeholder meeting
Sept 2011	Final report



Stakeholder meetings

- 1st meeting
 - Slides released on the website right after the meeting
 - Minutes published in July
- 2nd meeting
 - The date will be announced when releasing the Information Request on Tasks 4 and 5, base cases, BAT and BNAT
 - Tentatively beginning of December 2010 or of January 2011



Next reports / IR

- Comments on present draft reports are still useful
- Finalized draft reports 1, 2 and 3 including comments
 - Release in October
- IR on Tasks 4 and 5
 - Release in october with 6 weeks to send information
- Publication of draft reports on tasks 4 and 5 and task 3 model
 - Release before the second stakeholder meeting

Timetable

Stakeholder meetings

Draft reports



Thank you

Questions ?



Preliminary thoughts for base cases: V

A complete picture of AHU sales from all manufacturers would help to define the base cases

- **Important factors to define base cases**
 - Standard design VS design on demand
 - Occupancy type, periods, density
 - Pressure losses and tightness of the ductwork
 - Volume of the rooms
 - Climate type (regarding the energy loss associated to the V system)
 - Building and system use (control)



Preliminary thoughts for base cases: AC

- Important factors to define base cases
 - Building size
 - Max demand in W/m²
 - New bldg – new system, ex bldg – new system, ex bldg – ex system
 - Climate
 - Building occupancy type (office, retail, ...)
 - System architectures
 - Building and system use (control)

Ventilation

Air conditioning

Building type examples



Building typology proposal illustration

low rise

small office

medium/large
non-food shop

gym, store

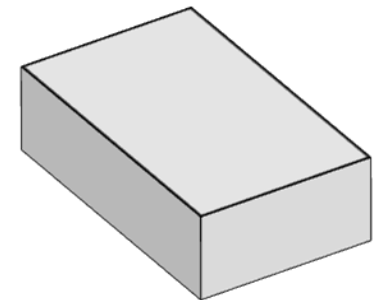
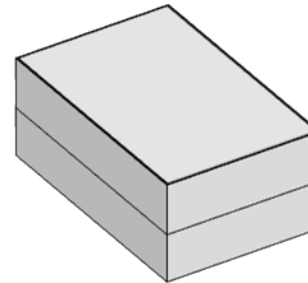
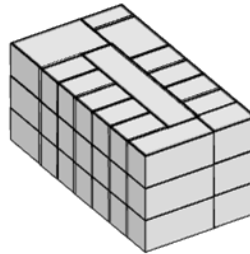
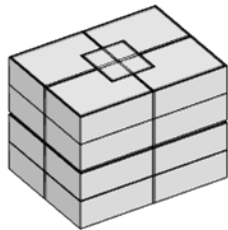
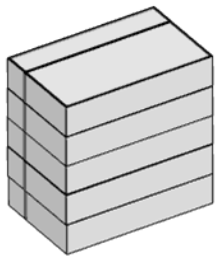

small school, open plan office

medium/small supermarket

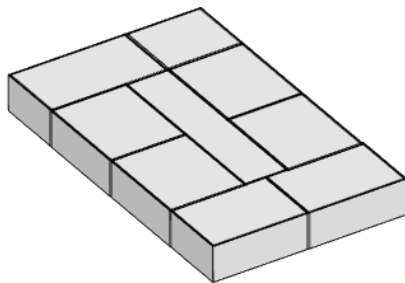

SMALL
700-800 m², 2000-2500 m³
ca. 85% of buildings
ca. 50% of built volume

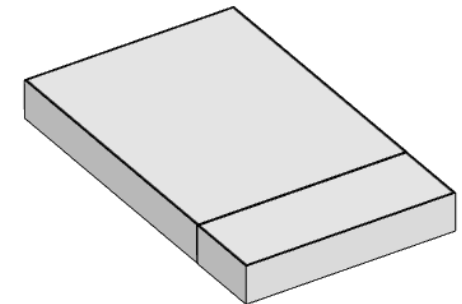



Building typology proposal illustration

medium rise

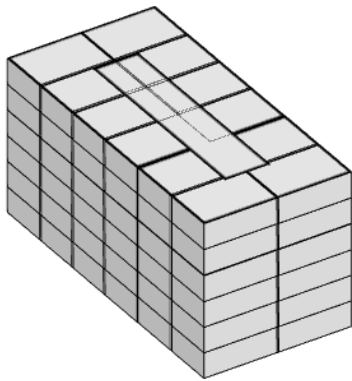

mixed, industrial

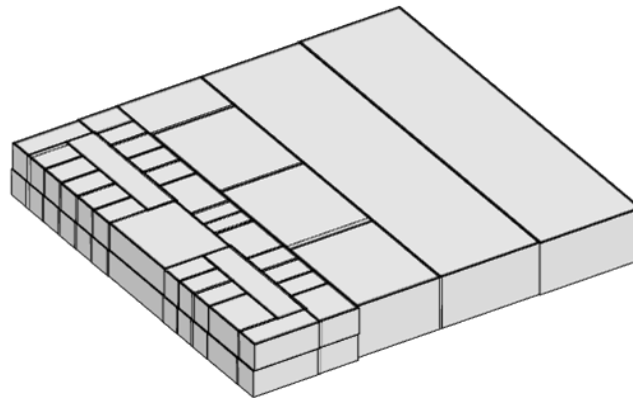

office (atrium)

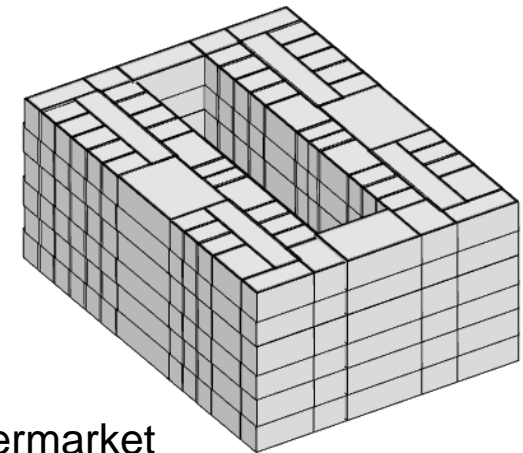

school, open plan office

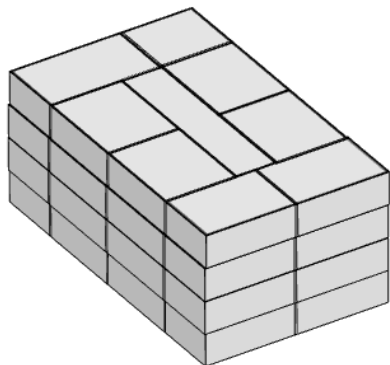

MEDIUM
2800 m², 10 000 m³
ca. 12% of buildings
ca. 25% of built volume

large supermarket
greenhouse
poultry
sports hall

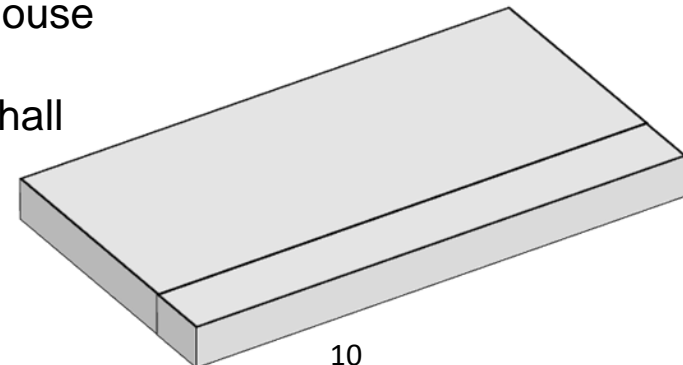



Building typology proposal illustration

high rise flat

large office, hospital, large hotel, mall, airport terminal, sports arena

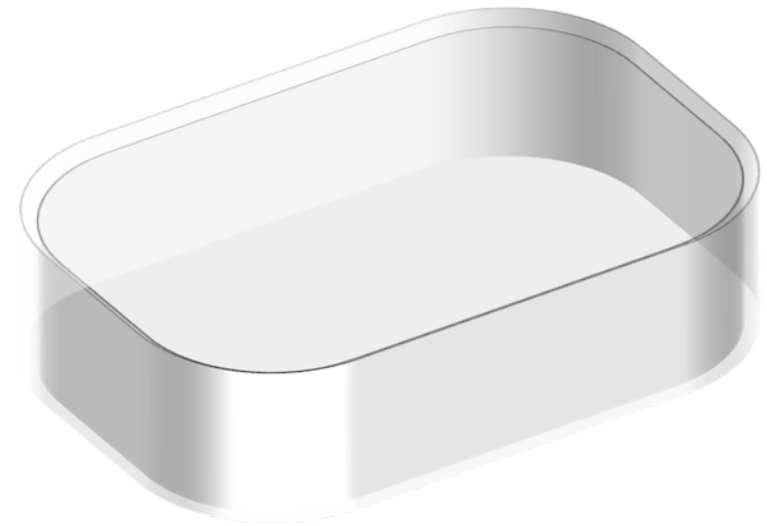
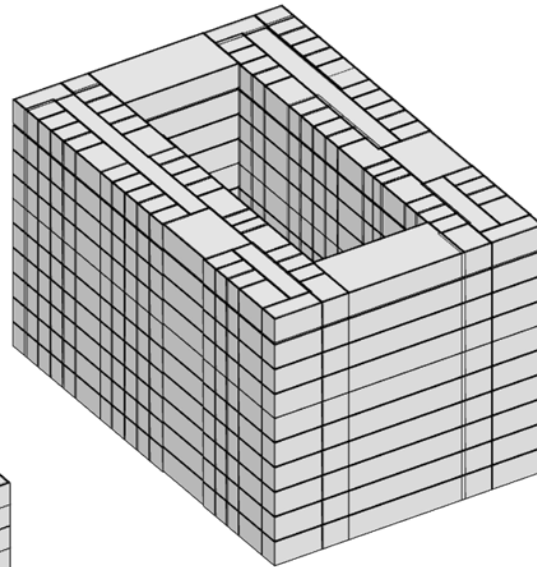
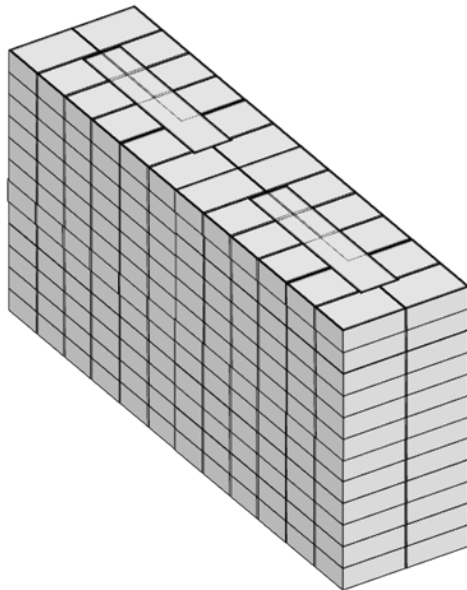

LARGE

10 000 m², 35 000 m³
ca. 3% of buildings
ca. 25% of built volume